

FOUNDATION PLAN
SCALE: 1/4"=1'-0"

FOUNDATION PLAN NOTES:
1. ALL FOUNDATION WORK SHALL BE IN ACCORDANCE WITH THE LATEST EDITIONS OF THE INTERNATIONAL RESIDENTIAL CODE BOOK (IRC) AND THE INTERNATIONAL FOUNDATION CODE BOOK (IFC).
2. ALL FOUNDATION WORK SHALL BE PERFORMED BY A LICENSED CONTRACTOR.
3. ALL FOUNDATION WORK SHALL BE SUBJECT TO INSPECTION BY THE LOCAL BUILDING DEPARTMENT.

STATISTICS:	
AREA:	EXISTING: PROPOSED:
FIRST FLOOR AREA:	N/A 2,801 S.F.
SECOND FLOOR AREA:	N/A N/A
TOTAL LIVING AREA:	N/A 2,801 S.F.
BASEMENT AREA:	N/A N/A
GARAGE AREA:	N/A 855 S.F.
TOTAL AREA:	N/A 3,656 S.F.

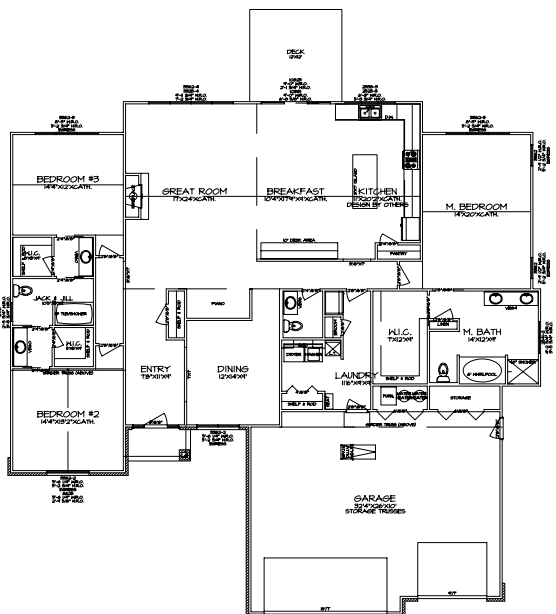

FIRST FLOOR PLAN
SCALE: 1/4"=1'-0"

FLOOR PLAN NOTES:
1. ALL INTERIOR FINISHES SHALL BE IN ACCORDANCE WITH THE LATEST EDITIONS OF THE INTERNATIONAL RESIDENTIAL CODE BOOK (IRC) AND THE INTERNATIONAL FOUNDATION CODE BOOK (IFC).
2. ALL INTERIOR WORK SHALL BE PERFORMED BY A LICENSED CONTRACTOR.
3. ALL INTERIOR WORK SHALL BE SUBJECT TO INSPECTION BY THE LOCAL BUILDING DEPARTMENT.

GALLIVAN'S
DRAFTING & DESIGN
(217) 202-5998

2801SF1SC.dwg